

RESOLUTION NO. 17-07

RESOLUTION EXPANDING RURAL SPECIAL
IMPROVEMENT MAINTENANCE DISTRICT #796M
(SOUTH 80TH ST WEST- ROAD)

WHEREAS, pursuant to §7-12-2161(4), MCA, the Commissioners have the power of changing, by resolution, the boundaries of any maintenance district not more than once a year; and

WHEREAS the boundaries of RSID 796M have not been changed within the last year; and

WHEREAS, it has been determined that properties adjacent to the existing Rural Special Improvement District #796M boundaries are benefited properties accessing the district roads; and

WHEREAS, the benefited property status requires the expansion of boundaries for RSID 796M for the maintenance of the road located within the district boundaries; and

WHEREAS, the boundaries of the district will be expanded to include S12, T01 S, R24E, COS 1385 Parcel 3A, Yellowstone County, Montana, described in Exhibit B; and

WHEREAS, lots to be added to the district and boundaries of the expanded district are shown in Exhibit A (map).

NOW, THEREFORE, BE IT RESOLVED by the Board of County Commissioners of Yellowstone County, Montana, deeming the public interest or convenience require, intends to expand the following described Rural Special Improvement Maintenance District:

1. **DESCRIPTION OF IMPROVEMENTS, DESCRIPTION OF MAINTENANCE, METHOD OF ASSESSMENT AND ESTIMATED COSTS.** Assessments collected on behalf of this district shall be used for the maintenance, preservation, and repair of curb, gutter and road located within the boundaries of this district. All of the costs of the district shall be assessed equally on a per lot method for existing and future lots. Assessments will be established annually by the Board of County Commissioners and are subject to adjustment due to cost fluctuations related to maintenance utilization levels and changes in material and labor costs of performing necessary maintenance.
2. **DURATION.** The district shall be deemed to be perpetual in nature unless absorbed and replaced by another district or municipality.

Page 2
Resolution Expanding
RSID #796M

PASSED AND ADOPTED by the Board of County Commissioners of Yellowstone
County, Montana, this 24th day of January, 2017.

BOARD OF COUNTY COMMISSIONERS
YELLOWSTONE COUNTY, MONTANA

John Ostlund, Chairman

Robyn Driscoll, Member

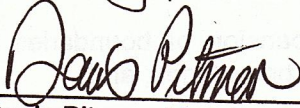

Denis Pitman, Member

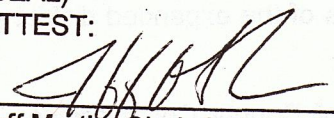
(SEAL)
ATTEST:

Jeff Martin, Clerk & Recorder
Yellowstone County, Montana

RSID 796M & New Proposed Boundary

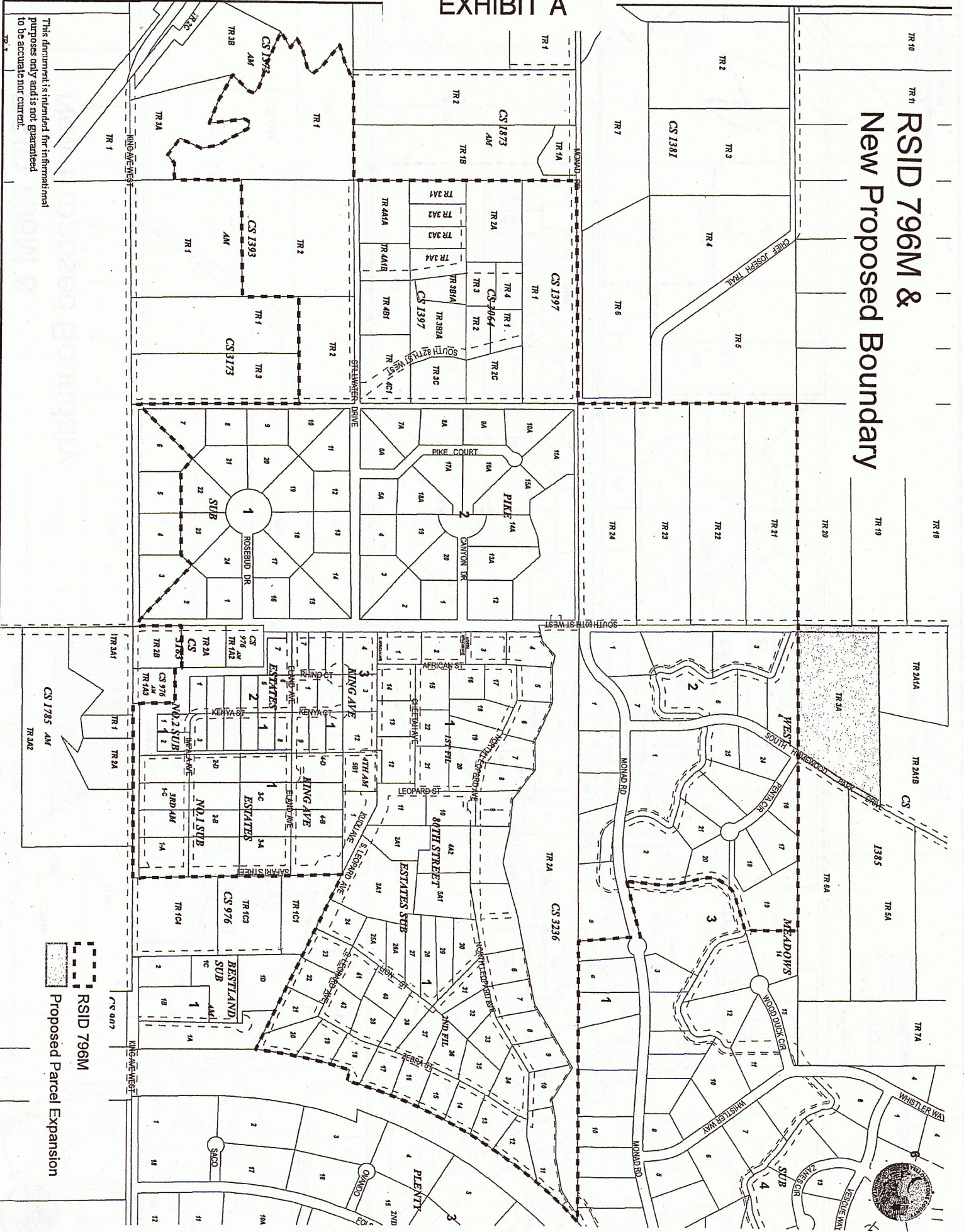
EXHIBIT A



This document is intended for informational purposes only and is not guaranteed to be accurate nor current.

RSID 796M
Proposed Parcel Expansion

RSID 796M & New Proposed Boundary

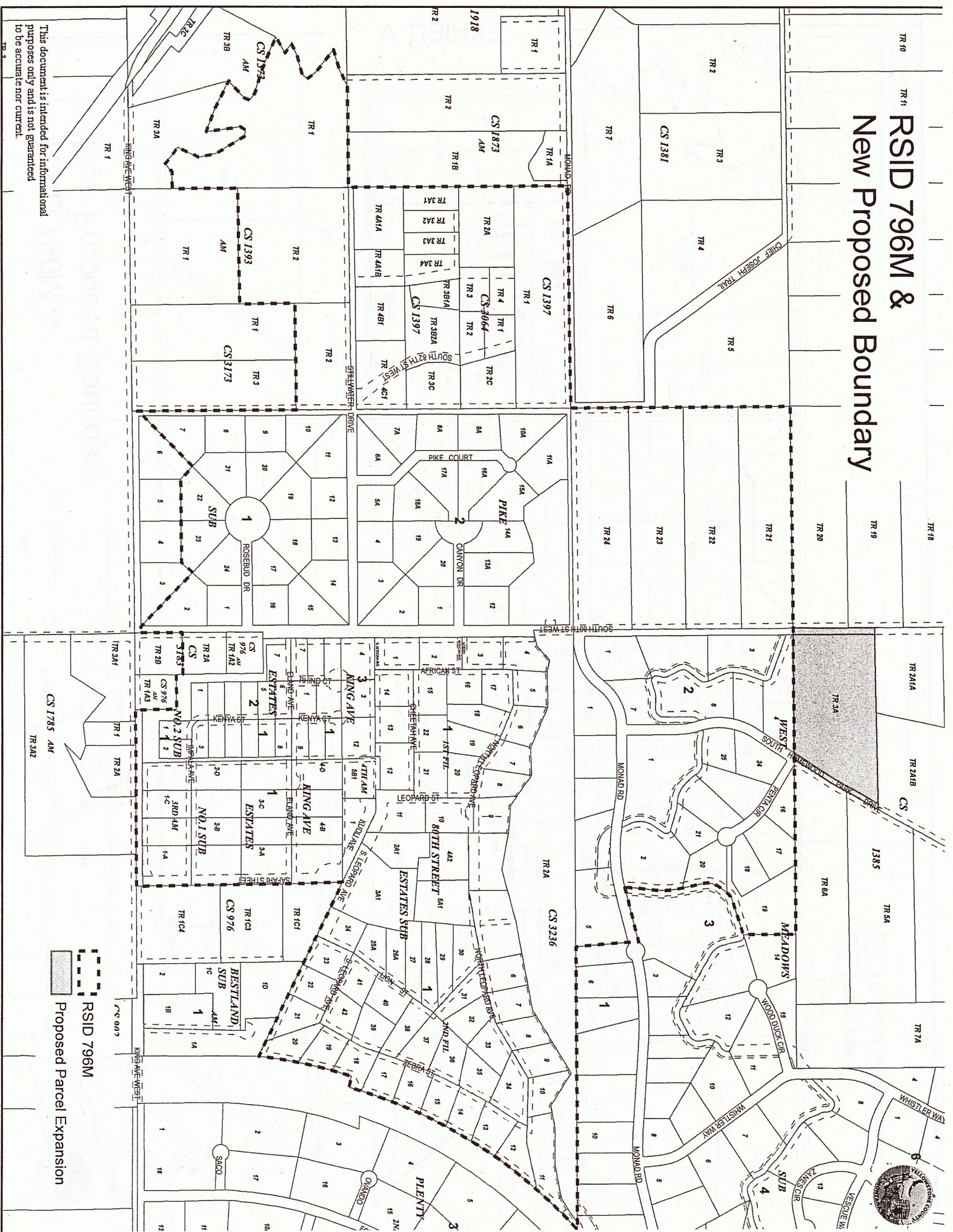

This document is intended for informational purposes only and is not guaranteed to be accurate nor current.

RSID 796M
 Proposed Parcel Expansion

EXHIBIT B

Table with columns: Tax ID, Current Assessment, Owner, Address, Mailing Address, City, ST, Zip, Legal Description. The table lists numerous property records with their respective tax identification numbers, current assessment values, owner names, and physical addresses. It includes details such as street names, lot numbers, acreage, and subdivision names like 'BEARTOOTH TRUST' or 'LEOPARD AVE'.

Table with 5 columns: Parcel ID, Owner Name, Address, City/Town, and Parcel Description. The table lists numerous parcels across various municipalities including Kennebunk, Kennebunkport, and Kennebunk Island. Each entry includes a unique parcel ID, the name of the owner, the full street address, and a brief description of the parcel's status or use.

| | | | | | | | | |
|-----------------------------------|------------|--|--------------------|--------------------|--------|----|------------|---|
| 141 C16409 | \$42.00 | LEBRAND, MARTIN & HOXANNE | 439 ZEBRA ST | 499 ZEBRA ST | BLINDS | MT | 59106-3023 | 80TH STREET ESTATES SUB 2ND FL (09), S12, T01 S, R24 E, BLOCK 1, Lot 13 |
| 142 C16410 | \$42.00 | SHARBONO, ANNA E | 509 ZEBRA ST | 509 ZEBRA ST | BLINDS | MT | 59106-3024 | 80TH STREET ESTATES SUB 2ND FL (09), S12, T01 S, R24 E, BLOCK 1, Lot 14 |
| 143 C16411 | \$42.00 | HAGENBUCH, JACOB T & WATLIN M | 519 ZEBRA ST | 519 ZEBRA ST | BLINDS | MT | 59106-3024 | 80TH STREET ESTATES SUB 2ND FL (09), S12, T01 S, R24 E, BLOCK 1, Lot 15 |
| 144 C16412 | \$42.00 | VAN LUCHEHE, AARON R | 529 ZEBRA ST | 529 ZEBRA ST | BLINDS | MT | 59106-3024 | 80TH STREET ESTATES SUB 2ND FL (09), S12, T01 S, R24 E, BLOCK 1, Lot 16 |
| 145 C16413 | \$42.00 | ALDEN, JOHN BRADROD & LINDA M | 539 ZEBRA ST | 539 ZEBRA ST | BLINDS | MT | 59106-3024 | 80TH STREET ESTATES SUB 2ND FL (09), S12, T01 S, R24 E, BLOCK 1, Lot 17 |
| 146 C16414 | \$42.00 | WAGONER, LARRY & DEANN | 607 ZEBRA ST | 607 ZEBRA ST | BLINDS | MT | 59106-3023 | 80TH STREET ESTATES SUB 2ND FL (09), S12, T01 S, R24 E, BLOCK 1, Lot 18 |
| 147 C16415 | \$42.00 | CURT & MAUREN MCCAMISH FAMILY TRUST | 615 ZEBRA ST | 615 ZEBRA ST | BLINDS | MT | 59106-3023 | 80TH STREET ESTATES SUB 2ND FL (09), S12, T01 S, R24 E, BLOCK 1, Lot 18 |
| 148 C16416 | \$42.00 | BRITTON, LEVI J & BARBARA L | 629 ZEBRA ST | 7623 N LEOPARD AVE | BLINDS | MT | 59106-2510 | 80TH STREET ESTATES SUB 2ND FL (09), S12, T01 S, R24 E, BLOCK 1, Lot 20 |
| 149 C16417 | \$42.00 | HARPER, DAVID D | 7666 S LEOPARD AVE | 7666 S LEOPARD AVE | BLINDS | MT | 59106-2511 | 80TH STREET ESTATES SUB 2ND FL (09), S12, T01 S, R24 E, BLOCK 1, Lot 20 |
| 150 C16418 | \$42.00 | WALTER, TONIA A & GARY W | 7676 S LEOPARD AVE | 7676 S LEOPARD AVE | BLINDS | MT | 59106-2511 | 80TH STREET ESTATES SUB 2ND FL (09), S12, T01 S, R24 E, BLOCK 1, Lot 22 |
| 151 C16419 | \$42.00 | SURSELY, JAMES D | 7675 S LEOPARD AVE | 7623 N LEOPARD AVE | BLINDS | MT | 59106-2511 | 80TH STREET ESTATES SUB 2ND FL (09), S12, T01 S, R24 E, BLOCK 1, Lot 22 |
| 152 C16420 | \$42.00 | BRITTON, LEVI J & BARBARA L | 602 LON ST | 602 LON ST | BLINDS | MT | 59106-2512 | 80TH STREET ESTATES SUB 2ND FL (09), S12, T01 S, R24 E, BLOCK 1, Lot 23 |
| 153 C16421 | \$42.00 | BRITTON, LEVI J & BARBARA L | 554 LON ST | 7623 N LEOPARD AVE | BLINDS | MT | 59106-2510 | 80TH STREET ESTATES SUB 2ND FL (09), S12, T01 S, R24 E, BLOCK 1, Lot 24 |
| 154 C16422 | \$42.00 | BRITTON, LEVI J & BARBARA L | 544 LON ST | 7623 N LEOPARD AVE | BLINDS | MT | 59106-2510 | 80TH STREET ESTATES SUB 2ND FL (09), S12, T01 S, R24 E, BLOCK 1, Lot 25 |
| 155 C16423 | \$42.00 | BRITTON, LEVI J & BARBARA L | 534 LON ST | 7623 N LEOPARD AVE | BLINDS | MT | 59106-2510 | 80TH STREET ESTATES SUB 2ND FL (09), S12, T01 S, R24 E, BLOCK 1, Lot 26 |
| 156 C16424 | \$42.00 | BRITTON, LEVI J & BARBARA L | 524 LON ST | 7623 N LEOPARD AVE | BLINDS | MT | 59106-2510 | 80TH STREET ESTATES SUB 2ND FL (09), S12, T01 S, R24 E, BLOCK 1, Lot 27 |
| 157 C16425 | \$42.00 | BRITTON, LEVI J & BARBARA L | 514 LON ST | 7623 N LEOPARD AVE | BLINDS | MT | 59106-2510 | 80TH STREET ESTATES SUB 2ND FL (09), S12, T01 S, R24 E, BLOCK 1, Lot 28 |
| 158 C16426 | \$42.00 | BRITTON, LEVI J & BARBARA L | 7710 N LEOPARD AVE | 7623 N LEOPARD AVE | BLINDS | MT | 59106-2510 | 80TH STREET ESTATES SUB 2ND FL (09), S12, T01 S, R24 E, BLOCK 1, Lot 29 |
| 159 C16427 | \$42.00 | BRITTON, LEVI J & BARBARA L | 7622 N LEOPARD AVE | 7623 N LEOPARD AVE | BLINDS | MT | 59106-2510 | 80TH STREET ESTATES SUB 2ND FL (09), S12, T01 S, R24 E, BLOCK 1, Lot 30 |
| 160 C16428 | \$42.00 | BRITTON, LEVI J & BARBARA L | 7618 N LEOPARD AVE | 7623 N LEOPARD AVE | BLINDS | MT | 59106-2510 | 80TH STREET ESTATES SUB 2ND FL (09), S12, T01 S, R24 E, BLOCK 1, Lot 31 |
| 161 C16429 | \$42.00 | REINICHE, MICHAEL | 7612 N LEOPARD AVE | 7623 N LEOPARD AVE | BLINDS | MT | 59106-2510 | 80TH STREET ESTATES SUB 2ND FL (09), S12, T01 S, R24 E, BLOCK 1, Lot 31 |
| 162 C16430 | \$42.00 | STEVENS, SCOTT & AMBER MAE | 7608 N LEOPARD AVE | 7623 N LEOPARD AVE | BLINDS | MT | 59106-2510 | 80TH STREET ESTATES SUB 2ND FL (09), S12, T01 S, R24 E, BLOCK 1, Lot 32 |
| 163 C16431 | \$42.00 | BURT, ADAM R & TAMI L | 508 ZEBRA ST | 508 ZEBRA ST | BLINDS | MT | 59106-3034 | 80TH STREET ESTATES SUB 2ND FL (09), S12, T01 S, R24 E, BLOCK 1, Lot 33 |
| 164 C16432 | \$42.00 | USELMAN, ADAM L & DANIELLE L | 518 ZEBRA ST | 518 ZEBRA ST | BLINDS | MT | 59106-3034 | 80TH STREET ESTATES SUB 2ND FL (09), S12, T01 S, R24 E, BLOCK 1, Lot 34 |
| 165 C16433 | \$42.00 | POWERS, JAD THOMAS & | 521 LON ST | 521 LON ST | BLINDS | MT | 59106-3034 | 80TH STREET ESTATES SUB 2ND FL (09), S12, T01 S, R24 E, BLOCK 1, Lot 35 |
| 166 C16434 | \$42.00 | GREENFIELD, KRANG & ERNIE N | 527 LON ST | 527 LON ST | BLINDS | MT | 59106-2509 | 80TH STREET ESTATES SUB 2ND FL (09), S12, T01 S, R24 E, BLOCK 1, Lot 36 |
| 167 C16435 | \$42.00 | STEVENSON, MELVYN R & SYLVIA | 600 ZEBRA ST | 600 ZEBRA ST | BLINDS | MT | 59106-2509 | 80TH STREET ESTATES SUB 2ND FL (09), S12, T01 S, R24 E, BLOCK 1, Lot 37 |
| 168 C16436 | \$42.00 | CHIDESTER, JAMES & MARIANNE | 537 LON ST | 537 LON ST | BLINDS | MT | 59106-2509 | 80TH STREET ESTATES SUB 2ND FL (09), S12, T01 S, R24 E, BLOCK 1, Lot 38 |
| 169 C16437 | \$42.00 | BIRGE, DANIEL A & JEAN K | 553 LON ST | 553 LON ST | BLINDS | MT | 59106-2509 | 80TH STREET ESTATES SUB 2ND FL (09), S12, T01 S, R24 E, BLOCK 1, Lot 39 |
| 170 C16438 | \$42.00 | KERNE, BILL & DARLENE A | 612 ZEBRA ST | 612 ZEBRA ST | BLINDS | MT | 59106-3038 | 80TH STREET ESTATES SUB 2ND FL (09), S12, T01 S, R24 E, BLOCK 1, Lot 40 |
| 171 D00124 | \$42.00 | KEENE, BILL & DARLENE A | 1819 AVENUE D | 1819 AVENUE D | BLINDS | MT | 59106-3038 | 80TH STREET ESTATES SUB 2ND FL (09), S12, T01 S, R24 E, BLOCK 1, Lot 41 |
| 172 D00125 | \$42.00 | KEENE, BILL & DARLENE A | 1819 AVENUE D | 1819 AVENUE D | BLINDS | MT | 59102-2927 | S11, T01 S, R24 E, C.O.S. 1425, PARCEL 12 |
| 173 D00126 | \$42.00 | KEENE, BILL & DARLENE A | 1819 AVENUE D | 1819 AVENUE D | BLINDS | MT | 59102-2927 | S11, T01 S, R24 E, C.O.S. 1425, PARCEL 21 |
| 174 D00127 | \$42.00 | KEENE, BILL & DARLENE A | 1819 AVENUE D | 1819 AVENUE D | BLINDS | MT | 59102-2927 | S11, T01 S, R24 E, C.O.S. 1425, PARCEL 22 |
| 175 D00128 | \$42.00 | VOSS, FRANCES M | 828 STILLWATER DR | 828 STILLWATER DR | BLINDS | MT | 59106-1808 | S11, T01 S, R24 E, C.O.S. 1397, PARCEL 2A, SENE |
| 176 D00129 | \$42.00 | BIRANI, LEE CAMPSON & ANASTASIA MALONE CAMPSON | 828 STILLWATER DR | 828 STILLWATER DR | BLINDS | MT | 59106-1808 | S11, T01 S, R24 E, C.O.S. 1397, PARCEL 2A, SENE |
| 177 D00130 | \$42.00 | SVENSON, IAN TH | 825 STILLWATER DR | 7790 HILPALM AVE | BLINDS | MT | 59106-1808 | S11, T01 S, R24 E, C.O.S. 1397, PARCEL 3A, SENE |
| 178 D00131 | \$42.00 | BAUWENS, RUSSELL R | 440 S 83RD ST W | 448 S 83RD ST W | BLINDS | MT | 59106-1808 | S11, T01 S, R24 E, C.O.S. 1397, PARCEL 3A, SENE |
| 179 D00132 | \$42.00 | EDDY, THOMAS E & NOMMA J | 512 S 83RD ST W | 512 S 83RD ST W | BLINDS | MT | 59106-1808 | S11, T01 S, R24 E, C.O.S. 1397, PARCEL 3A, SENE |
| 180 D00133 | \$42.00 | BRUSIO, JORDAN W | 511 S 83RD ST W | 511 S 83RD ST W | BLINDS | MT | 59106-1808 | S11, T01 S, R24 E, C.O.S. 1397, PARCEL 3A, SENE |
| 181 D00134 | \$42.00 | MYERS, WILLARD L & JULIE A | 512 S 83RD ST W | 512 S 83RD ST W | BLINDS | MT | 59106-1808 | S11, T01 S, R24 E, C.O.S. 1397, PARCEL 3A, SENE |
| 182 D00135A | \$42.00 | EDDY, THOMAS E & NOMMA J | 512 S 83RD ST W | 512 S 83RD ST W | BLINDS | MT | 59106-1808 | S11, T01 S, R24 E, C.O.S. 1397, PARCEL 3A, SENE |
| 183 D00136 | \$42.00 | RITSERA, DANIEL P | 512 S 83RD ST W | 512 S 83RD ST W | BLINDS | MT | 59106-1808 | S11, T01 S, R24 E, C.O.S. 1397, PARCEL 3A, SENE |
| 184 D00137 | \$42.00 | BRUSIO, LOHI R | 512 S 83RD ST W | 512 S 83RD ST W | BLINDS | MT | 59106-1808 | S11, T01 S, R24 E, C.O.S. 1397, PARCEL 3A, SENE |
| 185 D00138 | \$42.00 | BRUSIO, LOHI R | 512 S 83RD ST W | 512 S 83RD ST W | BLINDS | MT | 59106-1808 | S11, T01 S, R24 E, C.O.S. 1397, PARCEL 3A, SENE |
| 186 D00139 | \$42.00 | BRUSIO, LOHI R | 512 S 83RD ST W | 512 S 83RD ST W | BLINDS | MT | 59106-1808 | S11, T01 S, R24 E, C.O.S. 1397, PARCEL 3A, SENE |
| 187 D00140 | \$42.00 | BRUSIO, BETHANY R | 8340 BRUSIO LN | 8340 BRUSIO LN | BLINDS | MT | 59106-2504 | S11, T01 S, R24 E, C.O.S. 1397, PARCEL 3A2 |
| 188 D00141 | \$42.00 | KILWEN, JEFFREY A | 520 S 83RD ST W | 520 S 83RD ST W | BLINDS | MT | 59106-2504 | S11, T01 S, R24 E, C.O.S. 1397, PARCEL 3A2 |
| 189 D00142 | \$42.00 | KILWEN, JEFFREY A | 520 S 83RD ST W | 520 S 83RD ST W | BLINDS | MT | 59106-2504 | S11, T01 S, R24 E, C.O.S. 1397, PARCEL 3A2 |
| 190 D00143 | \$42.00 | HANSON, SUZANNE | 825 STILLWATER DR | 825 STILLWATER DR | BLINDS | MT | 59106-1809 | S11, T01 S, R24 E, C.O.S. 1397, PARCEL 4A1A, AMND |
| 191 D00144 | \$42.00 | TEITZLAFF, RAYMOND S | 825 STILLWATER DR | 825 STILLWATER DR | BLINDS | MT | 59106-1809 | S11, T01 S, R24 E, C.O.S. 1397, PARCEL 4A1B, AMND 4A1 (79) |
| 192 D00145 | \$42.00 | ARNETT, MARGIE & JAMES | 703 S 80TH ST W | 703 S 80TH ST W | BLINDS | MT | 59106-0754 | S11, T01 S, R24 E, C.O.S. 1397, PARCEL 4B1, 2ND AMND TR 4 (79) |
| 193 D00146A | \$42.00 | ARNETT, MARTHA P | 703 S 80TH ST W | 703 S 80TH ST W | BLINDS | MT | 59106-0754 | S11, T01 S, R24 E, C.O.S. 1397, PARCEL 4B1, 2ND AMND TR 4 (79) |
| 193 D00146B | \$42.00 | ARNETT, MARTHA P | 703 S 80TH ST W | 703 S 80TH ST W | BLINDS | MT | 59106-0754 | S11, T01 S, R24 E, C.O.S. 1397, PARCEL 4B1, 2ND AMND TR 4 (79) |
| 194 D00147 | \$42.00 | MILLER, KEVIN W | 544 AMERICAN ST | 544 AMERICAN ST | BLINDS | MT | 59106-2501 | S12, T01 S, R24 E, C.O.S. 976, PARCEL 1A2, AMEND TR 1A |
| 195 D00148 | \$42.00 | WOOL, MAE W TRULSTEE | 488 S 82ND ST W | 488 S 82ND ST W | BLINDS | MT | 59106-512 | T01 S, R24 E, C.O.S. 3183, PARCEL 2A, AMND (09) |
| 196 D12615 | \$42.00 | KGARISE, RICHARD A | 460 S 82ND ST W | 460 S 82ND ST W | BLINDS | MT | 59106-2897 | S12, T01 S, R24 E, C.O.S. 3236, PARCEL 1, Lot 1, 1095 AC |
| 197 D12616 | \$42.00 | KGARISE, RICHARD | 455 S 82ND ST W | 455 S 82ND ST W | BLINDS | MT | 59106-1878 | S11, T01 S, R24 E, C.O.S. 3064, PARCEL 1 |
| 198 D12617 | \$42.00 | KGARISE, DANIEL G & MELINDA L | 445 S 83RD ST W | 445 S 83RD ST W | BLINDS | MT | 59106-1878 | S11, T01 S, R24 E, C.O.S. 3064, PARCEL 1 |
| 199 D12618 | \$42.00 | UNDERWOOD, GARY F | 445 S 83RD ST W | 445 S 83RD ST W | BLINDS | MT | 59106-1878 | S11, T01 S, R24 E, C.O.S. 3064, PARCEL 1 |
| | \$8,358.00 | | | | | | | |
| | \$9,400.00 | | | | | | | |
| Parecels to include in exemption: | | | | | | | | |
| 200 D00161 | \$42.00 | NAUL, RANDALL GLEN & | 7623 N LEOPARD AVE | 7623 N LEOPARD AVE | BLINDS | MT | 59106-2510 | S12, T01 S, R24 E, C.O.S. 1385, PARCEL 3A, AMND (16) |